

PARTS LIST & DIAGRAM

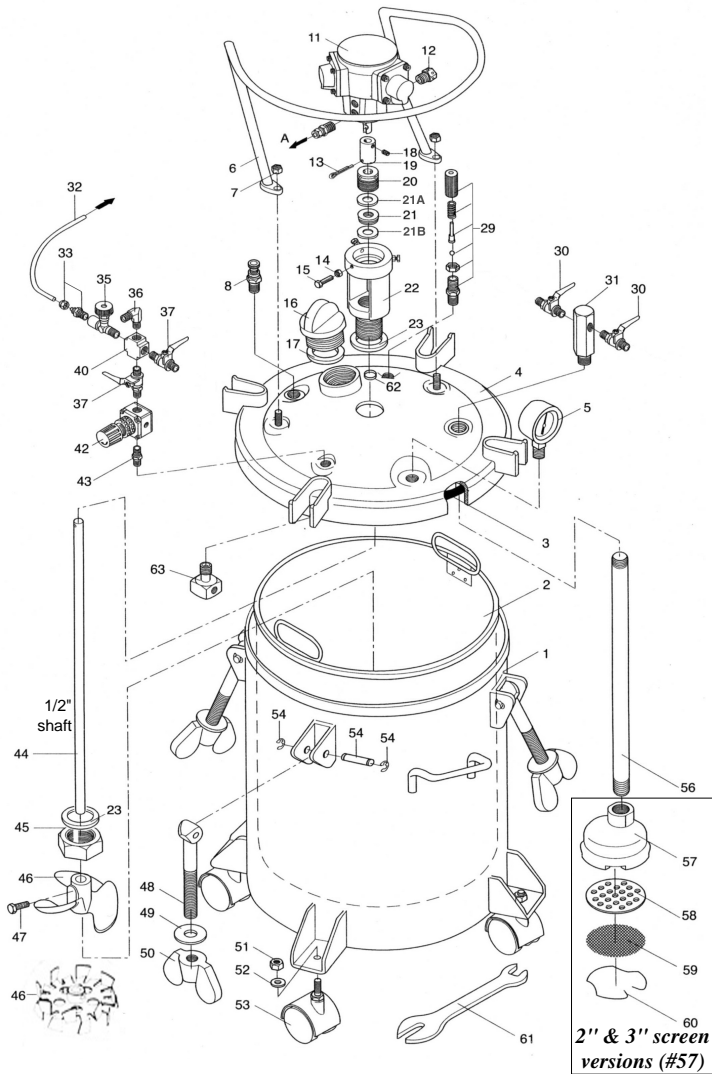

2.25 / 5 / 10 GALLON PRESSURE POT WITH AIR AGITATOR



Pos.	Part nos.	Description	Qty.
18	L015-193	set screw, 1/4NC x 1/4"	2
20	L011-297	Packing Nut	1
21	L011-340	Packing Kit (incl. pos #21A & B)	1
22	L011-298	Agitator adaptor, fits 2.5, 5, 10 gal.	1
23	L011-263	Sealing Ring	2
29	L011-264	Safety Valve assy. (incl. #24 - 29)	1
30	L011-265	Ball Valve, 1/4x3/8 NPT (1x for 2.5G)	2
31	L011-267	Outlet Tee (M16 for 1/2" M M19F pipe)	1
	L011-266	Outlet Tee (1/2" for 1/2" MM pipe)	1
	L011-266s	Outlet Tee (2.5G req 1x #72)	1
32	L035-300	Hose, air motor, per foot	0.75
33	L011-299	Air Fitting, threaded, (1/4M x 1/8H)	2
35	L011-549	Flow control valve, 1/4 NPT M-F	1
36	L035-571	Elbow, 1/4 NPT-M, 90 deg	1
37	L011-300	Ball Valve, 1/4M-M	2
40	L035-621	Cross, 1/4 NPT-F	1
42	L011-178	Regulator, 0-60 psi	1
43	L011-250	Air inlet adaptor	1
44	L011-301	Shaft, 11.5", 2.5G (may incl 13/19)	1
	L011-302	Shaft, 18.25", 5G (may incl 13/19)	1
	L011-302S	Shaft, 18.25", 5G SS (may incl 13/19)opt	1
	L011-303	Shaft, 24", 10G (may incl 13/19)	1
45	L011-269	Nut, agitator adaptor	1
46	L011-287	Propellor, Nylon 4" (10 Gal uses 2x)	1
	L011-287S	Propellor, SS flat 4", 1/2" shaft	opt
47	L011-304	Bolt, 5/16 x 3/4" (10G uses 2x) SS	1
48	L011-271	Swing Bolt	4
49	L011-272	Washer	4
50	L011-273	Wing Nut	4
51	L002-509	Nut, 3/8 NC	4
52	L002-508	Washer, 3/8	4
53	L011-274	Castor Wheel	4
54	L011-275	Retaining Pin Set (incl's clipx2, pinx1)	4
56	L011-305	Fluid Tube, 8.5" for 2.5G	1
	L011-276S	Fluid Tube, 14.5" for 5G(M16Fx1/2M)ss	1
	L011-276	Fluid Tube, 14.5" for 5G(1/2" MM)	1
	L011-306	Fluid Tube, 20.5" for 10G	1
57	L011-307	Suction filter 2" (incl.#58,59,60) (2.5G)	1
	L011-277	Suction filter 3" (incl.#58,59,60)(5/10G)	1
58	L011-308	Filter Support, 2"	1
	L011-247	Filter Support, 3"	1
59	L011-309	Suction screen, 2"	1
	L011-248	Suction screen, 3"	1
60	L011-312	Snap ring, 2"	1
	L011-249	Snap ring, 3"	1
61	L011-278	Wrench	1
62	L011-325	Viton O-ring, 11.5mm ID x 2mm	2
63	L011-251	Air inlet baffle	1
65	L011-341	Bolt, Allen head, 5/16"NC x 1"	2

Pos.	Part nos.	Description	Qty.
	L011-087	Pressure pot 2.25G w/airmotor (SS=060)	
	L011-088	Pressure pot 5G manual agi	
	L011-089	Pressure pot 5G w/airmotor (SS=062)	
	L011-091	Pressure pot 10G w/airmotor	
1	L011-288	Tank, 2.5 Gal. Agitated	1
	L011-240	Tank, 5 Gal.	1
	L011-289	Tank, 10 Gal.	1
2	L011-290	Stainless Steel Inner tank, 2.5 Gal	1
	L011-242	Stainless Steel Inner tank, 5 Gal	1
	L011-291	Stainless Steel Inner tank, 10 Gal	1
3	L011-292	Cover Gasket, all 2.5 Gal Agi, 11" O.D.	1
	L011-243	Cover Gasket, all 5 and 10 G, 13" O.D.	1
4	L011-293	Lid Assembly, 2.5 Gal. Agitated	1
	L011-241	Lid Assembly, 5 and 10 Gal.	1
5	L011-313	Air Gauge, 0-100 psi, 1/4" bottom	1
6	L011-294	Carrying Handle, 2.5 Gal	1
	L011-176	Carrying Handle, 5 and 10 Gal.	1
7	L002-713	Nut, 5/16" NC (4x on the 2.25G)	1
8	L011-246	Bleeder Valve Assembly	1
11	L011-295	Agitator Motor, 3-piston, 1/3 HP	1
12	L011-296	Muffler	1
14	L002-815	Nut, 1/4 NC	3
15	L002-709	Bolt, 1/4 NC x 3/4"	3
16	L011-258	Cap (5 and 10 Gal. only)	1
17	L011-259	Sealing Ring (5 and 10 Gal. only)	1

Accessories not shown on diagram:

66	L035-560	1/8 NPT Plug	3
67	L011-173	Decal, pressure pot settings	1
68	L011-278	Decal, 10", lemmer logo	1
69	L011-193	Gauge, 0-160 psi, 1/8"	1
70	L298-606	Regulator, 0-125 psi	1
71	L011-161	Nipple, 1/4 NPT M-M	1
72	L036-071	Plug, 1/4 NPT-M	1

Note: SS versions of the above pots have the following position numbers available in stainless steel as a special order: (1,4,6,7,22,30,31,44,45,46,48,49,50,54,56,65)

Weight Chart (lbs)

Size	Bare	Boxed
2.25G zinc	16.5	18
2.25G agi	39.5	43
2.25G agi ss	38	40
5G manual	54	59
5G agi	56.5	61.5
5G agi ss	55	59
10G agi	63	67.5

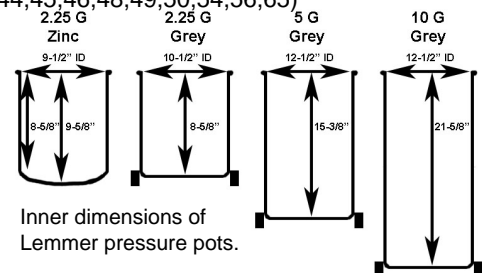

Specifications subject to change.